



WEST BURTON METHODIST CHAPEL

WEST BURTON, DL8 4JX

£96,000
FREEHOLD

OFFERED FOR SALE FOR COMMUNITY USE ONLY. A Detached Methodist Chapel dating back to 1898 within the heart of West Burton overlooking the village green. Current Use Class F1 (Learning and Non-residential Institutions). The Property comprises: Entrance Porch, Chapel Room, Vestry, Meeting Room, Side Hall, Outside WC, Cellar, Front Garden, Rear Yard. Mains electricity, water and drainage. Oil Fired Central Heating. EER N/a.

NORMAN F. BROWN

Est. 1967

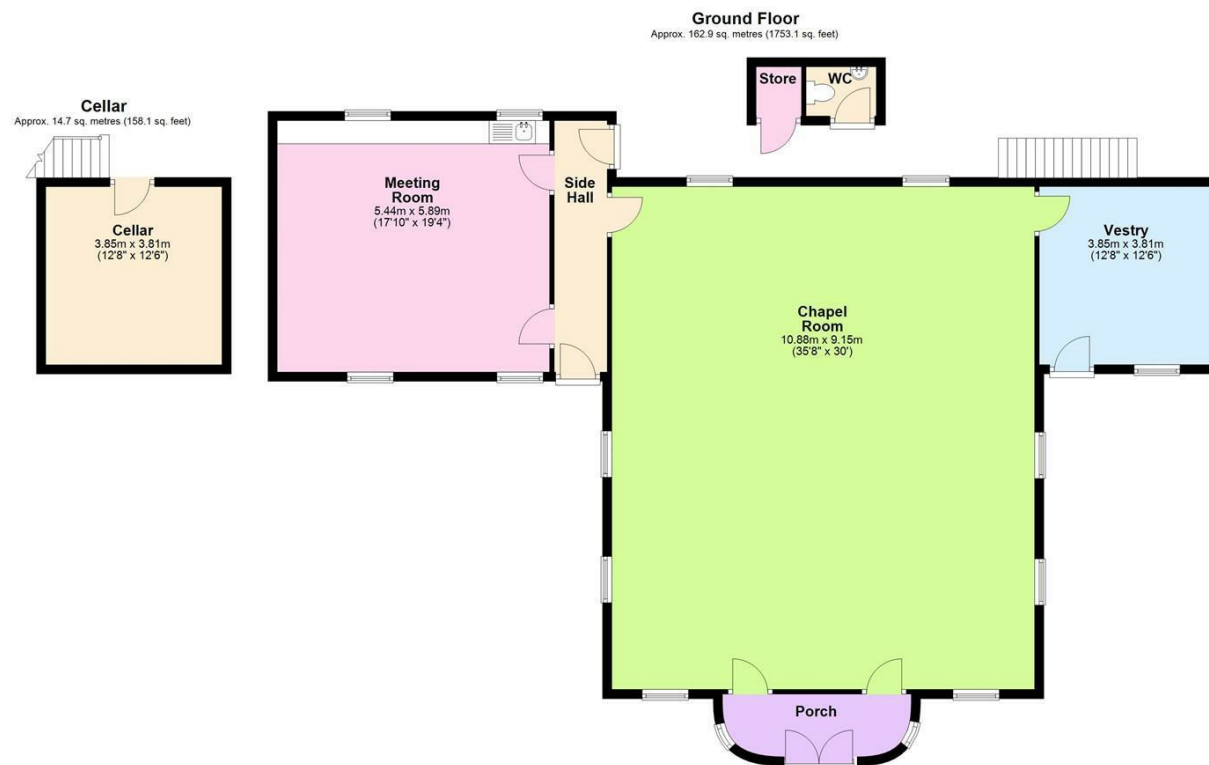

Total area: approx. 177.6 sq. metres (1911.2 sq. feet)



Agents Note: Whilst every care has been taken to prepare these particulars, they are for guidance purposes only. All measurements are approximate and are for general guidance purposes only and whilst every care has been taken to ensure their accuracy, they should not be relied upon and potential buyers/tenants are advised to recheck the measurements

Leyburn Office Commercial
25 Market Place
Leyburn
North Yorkshire
DL8 5AS

01969 622194
leyburn@normanfbrown.co.uk
www.normanfbrown.co.uk

NORMAN F.BROWN

Est. 1967